



# LIGHTING FOR **IMPACT**

*Transforming the way your customers  
see, shop, and spend...*

**INSTALLATION MANUAL**

1

## PEGGED PANEL — Power Strip Install

**1A:** Slide the power strip behind existing shelving and lower it until just above the base deck. Ensure the top and bottom labels are correct.

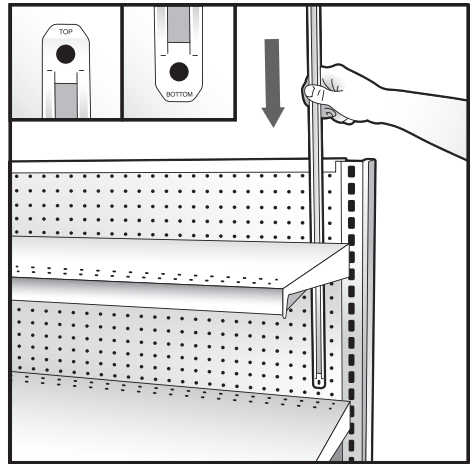

**1B:** For fixtures with peg hole backing, use two plastic rivets to secure the power strip through holes found in each cap.

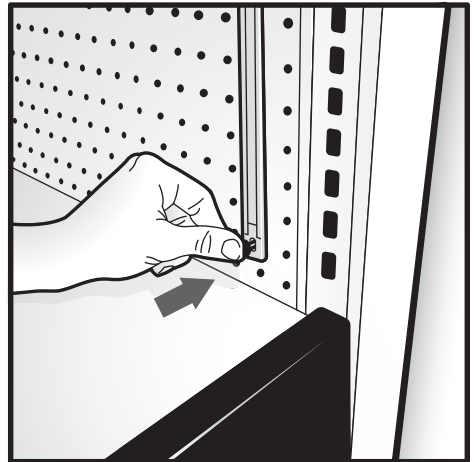

**[Optional] — 1C:** A containment strap has been provided if additional support is needed in the center of the power strip. Align the two pegs on the back of the strap with holes in the peg board, and push in place until it's flush with power strip.

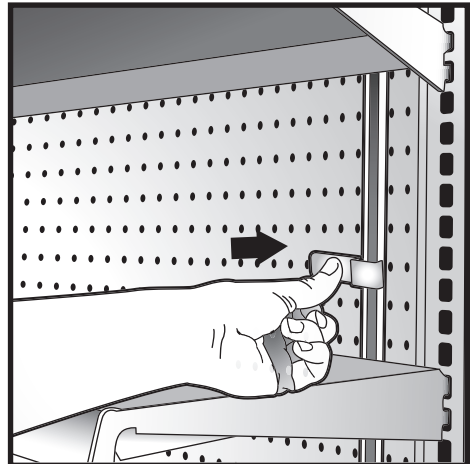

1

## SOLID PANEL — Power Strip Install

**1A:** Slide the power strip behind existing shelving and lower it until just above the base deck. Ensure the top and bottom labels are correct.

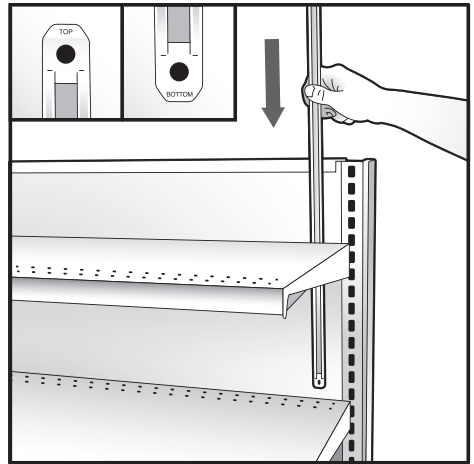

**1B:** For solid panel backing, use the two black wood screws provided.



**[Optional] — 1C:** Screw guides have been provided if additional support is needed in the center of the power strip. Snap the screw guide onto power strip in the desired location.

Align the **START** arrow with the power strip and gently push the connector into the strip. Rotate the connector clockwise until it snaps into place leaving the **LOCKED** arrow aligned with the power strip.

Once installed, position the black wood screw in the guide hole, screw through the power strip and into the backing panel.

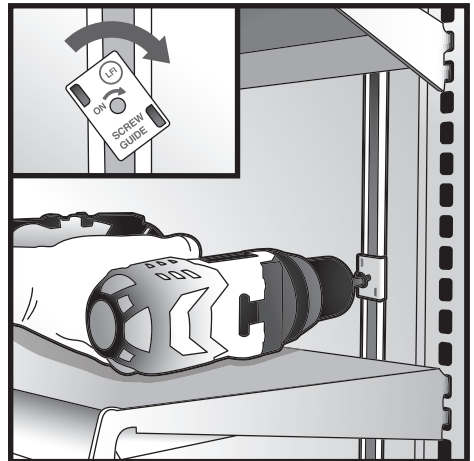

## Connecting Power

### 2A: Remove the Base Deck

Remove product from the base deck, and then remove the base deck and set it aside.

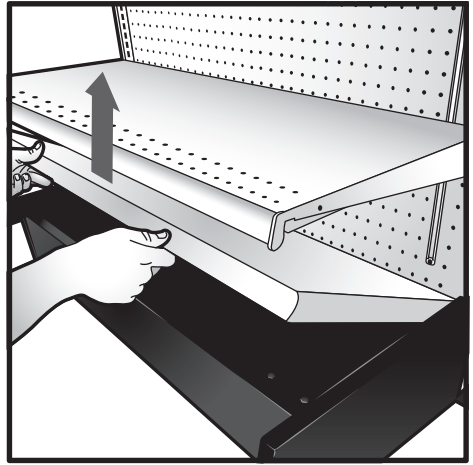

### 2B: Attach the Red Input Connector to the Power Strip

To snap the connector onto the power strip, first align the **START** arrow vertically with the power strip (as shown) and press the connector into the strip track. Ensure your connector is fully inserted and flush against power strip — then rotate clockwise. When it snaps into place leaving the **LOCKED** arrow aligned with the power strip, the connection is complete.

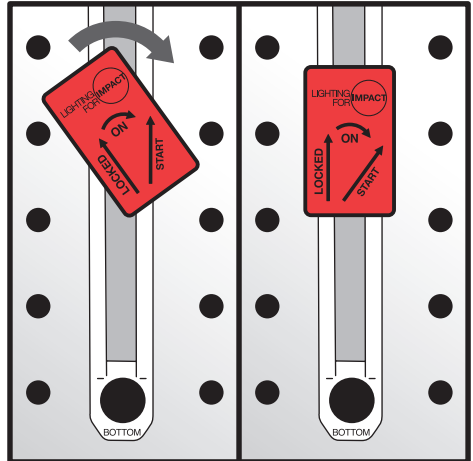

### 2C: Connect the Power Supply into the Red Input Connector

Use the short DC extension between the power supply and the input connector.

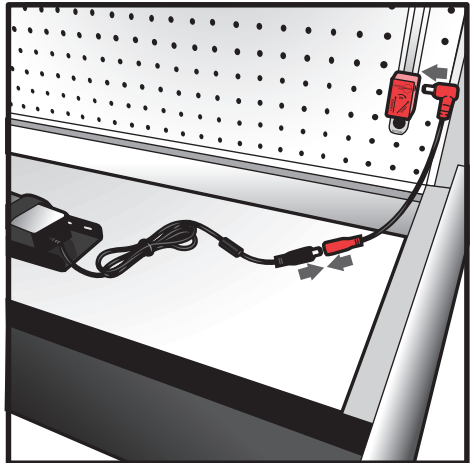

## [Continued] Connecting Power

### 2D: Mount Power Supply to Deck:

Attach the magnetic tray with the power supply to the bottom of the base deck. Use the magnetic clips to secure any excess wire to the bottom of the base deck.

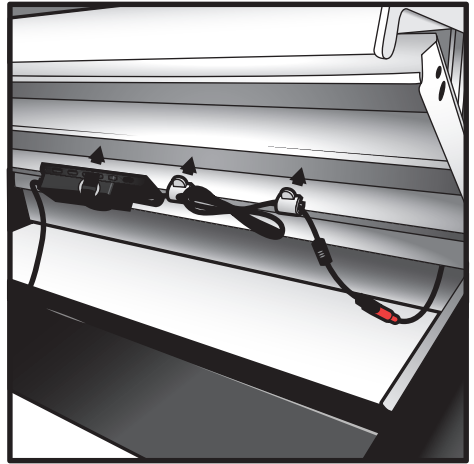

### 2E: Reinstall Base Deck:

Ensure the power cord runs safely behind the base deck.

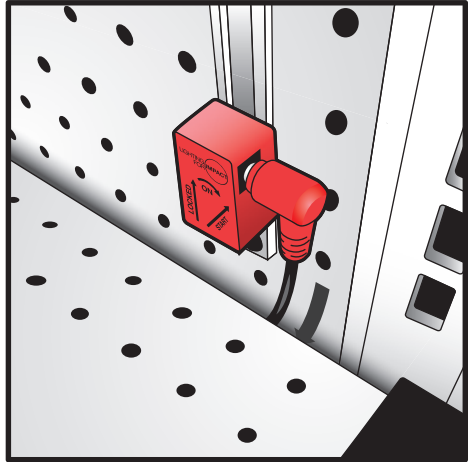

### NOTE: T-Series Connections

For multiple neighboring fixtures, plug the AC cord into the T-Series extension, then plug the T-Connector into the power adapter — (repeating as shown for each fixture).

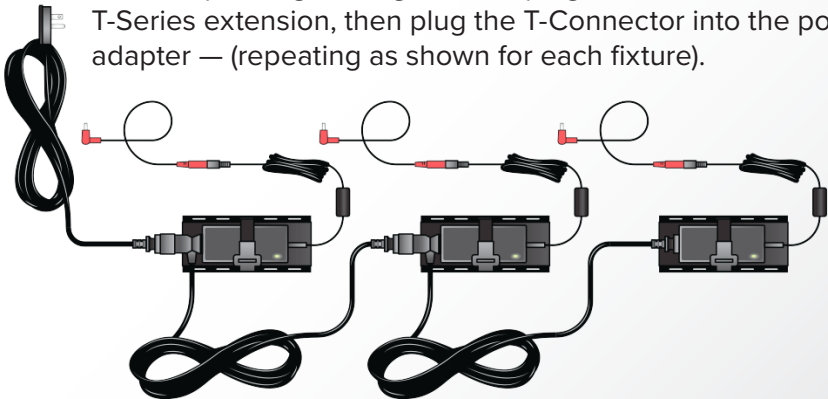

## METAL — Installing LED Channels

**3A:** Ensure the cord is on the same side as the power strip. Attach LED channel (with magnetized-side UP) onto the underside of shelf, then slide the channel toward the front-most edge (just behind ID channel).

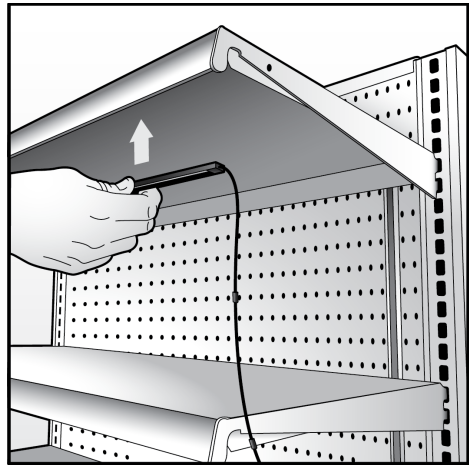

### 3B: Installing Power Output Connectors

Below each shelf, align the **START** arrow on the connector with the power strip. Gently push the connector into the power strip and rotate clockwise until it snaps into place leaving the **LOCKED** arrow aligned with the power strip. Once installed, insert the barrel plug on the LED cord into the output connector.

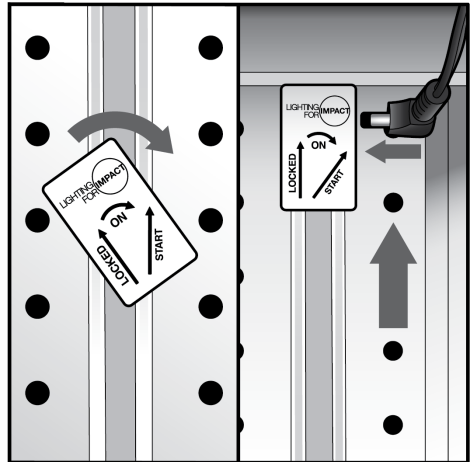

**3C:** The LED cord will include three (3) built-in clips to attach and manage the cord placement. Utilize these to secure the cord to the underside of shelf. If needed, the clips can be slid on the cord to reposition. This process will help keep the cord up and away from the product, shoppers, and staff.

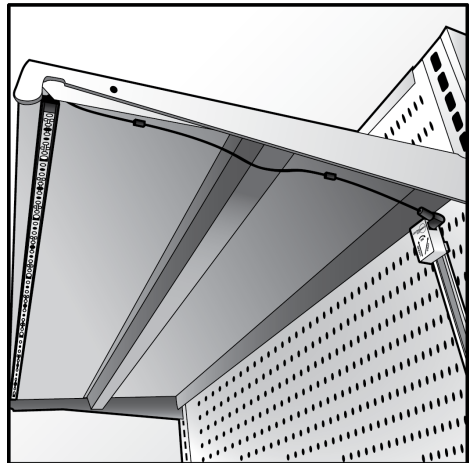

## WIRE — Installing LED Channels

**3A:** Position LED with the cord on the same side as power strip, place LED on top of the shelf with LEDs pointing down. Slide the strip toward the front edge of the shelf. Snap the plastic “U” clips over the LED and onto the shelf wire to secure the LED. Install one clip per foot of LED.

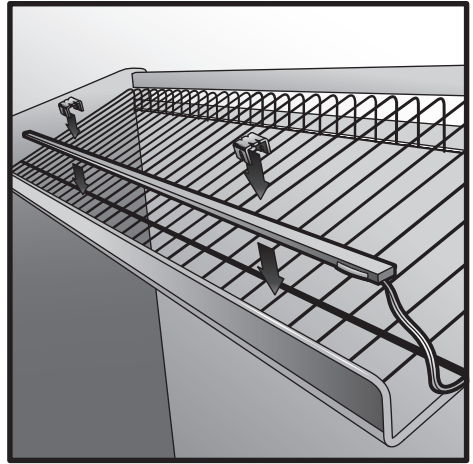

### 3B: Installing Power Output Connectors

Below each shelf, align the START arrow on the connector with the power strip. Gently push the connector into the power strip and rotate clockwise until it snaps into place leaving the **LOCKED** arrow aligned with the power strip. Once installed, insert the barrel plug on the LED cord into the output connector.

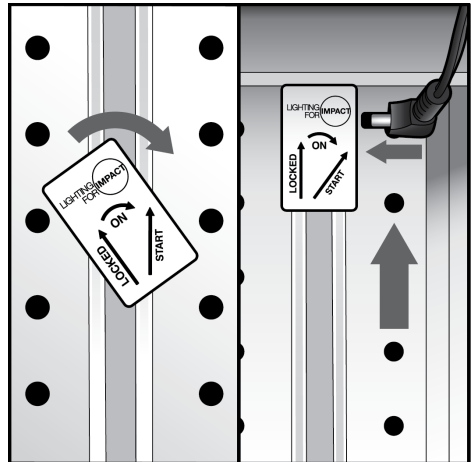

**3C:** Use the plastic “twist” clips to secure the LED cord to the wire shelving. Two clips are provided per shelf. First, insert the LED cord into a clip. Then, align clip with a wire on the shelf and twist to lock in place. These clips will help keep the cord up and away from the product.



## 5 Completing the Lighting for Impact System

Locate the nearest available power outlet, and plug in the last outlet-ready power cord in the power supply series. **CONGRATULATIONS!** The installation is now complete! Confirm that each LED channel is illuminated.

### Trouble Shooting:

- If none of the strips are illuminated, confirm that the outlet is active.
- Next, ensure any red input connector is properly attached to the power strip and that the red power cord is plugged into the input connector.
- If only one LED channel is not functioning, inspect the power output connector for that LED. Ensure it is properly attached to the power strip and that the LED is plugged into the output connector.

**IMPORTANT:** Each power supply/power strip combination is designed to power the number of LED channels shown in the chart below. While each supply is designed with built-in overload protection, too many LED strips will eventually cause the transformer to fail and reduce the life of your system. Follow the chart recommendations for optimal performance.

Power Supply Wattage	Number of LED Channels
24W	5
36W	8
60W	12
84W	18

**844.218.4412** | [www.lightingforimpact.com](http://www.lightingforimpact.com)

LIGHTINGFOR  IMPACT

Lighting for Impact | 3201 S. 6th Street, Lincoln, NE 68502

